

30th Reed M. Nesbit Urologic Society & Visiting Professor Meeting

October 15 and 16, 2015

M | UROLOGY

University of Michigan Medical School



The Reed M. Nesbit Urologic Society, founded in 1972, holds an annual meeting for urologists who trained or were affiliated with the University of Michigan Department of Urology. It is open to residents, fellows, faculty and interested community urologists. This year's program focuses on oncology and prostate cancer in particular. Recently there has been some controversy over the role of prostate specific antigen (PSA) in the early screening, detection and treatment and the new developing technology of magnetic resonance imaging as it applies to prostate cancer. Dr. Gerald Andriole, Robert K. Royce Distinguished Professor of Urologic Surgery and Chief, Division of Urologic Surgery at Washington University in St. Louis School of Medicine, is this year's guest professor.

After attending this activity, participants will be able to:

- 1) Define the role of PSA in early detection of prostate cancer.
- 2) Correctly utilize MRI fusion and its application in patients with elevated PSA and prior equivocal biopsies.
- 3) Implement new targeted treatments for advanced, high grade cancer.
- 4) Better prepared on the evaluation, testing and medical & surgical management of neurogenic bladder.
- 5) Understand the statewide urologic care consortium and its impact on statewide surgical outcomes.

The University of Michigan Medical School is accredited by the Accreditation Council for Continuing Medical Education (ACCME) to provide continuing medical education for physicians. The University of Michigan Medical School designates this live activity for a maximum of 7.75 *AMA PRA Category 1 Credit(s)*[™]. Physicians should claim only the credit commensurate with the extent of their participation in the activity.



Thursday, October 15, 2015

University of Michigan Medical Campus, Towsley Center, Sheldon Auditorium
1500 E. Medical Center Drive, Ann Arbor, MI 48109

- 1:00-1:30 PM **Registration (Lobby)**
- 1:30-1:45 PM **"Advancing Prostate Cancer Specific Early Detection Biomarkers"**
Scott Tomlins, MD, PhD
Assistant Professor, Departments of Pathology and Urology, University of Michigan
- 1:45-2:00 PM **"Making MUSIC: Collaborative Quality Improvement in Urology"**
David A. Miller, MD, MPH
Associate Professor, Department of Urology, University of Michigan
- 2:00-2:15 PM **"MRI/US Fusion Prostate Biopsy: Moving Prostate Cancer Diagnostics into the Modern Era"**
Jeffrey Montgomery, MD, MHSA
Associate Professor, Department of Urology, University of Michigan
- 2:15-2:30 PM **"Development of a Liquid Biopsy Assay for Precision-based Medicine"**
Todd Morgan, MD
Assistant Professor, Department of Urology, University of Michigan
- 2:30-2:45 PM **"Targeted Natural Killer Cell Therapy for Lethal Prostate Cancer"**
Ganesh Palapattu, MD
Associate Professor, Department of Urology, University of Michigan
- 2:45-3:00 PM **"Changing the Face of Men's Health: Movember Foundation's Ambitious Global Outreach to Prostate Cancer Survivors"**
Daniela Wittmann, PhD, LMSW
Assistant Professor, Department of Urology, University of Michigan
- 3:00-3:15 PM **Break**
- 3:15-4:00 PM **Case Presentation by Residents/Fellows**
Rebekah Beach, MD
Miriam Hadj-Moussa, MD
Lindsey Herrel, MD
Michael Kozminski, MD
Amy Li, MD
- 4:00-4:45 PM **"How Bad Prostate Biopsy Has Held Us Back"**
Gerald L. Andriole, Jr., MD
Robert K. Royce Distinguished Professor of Urologic Surgery
Chief, Division of Urologic Surgery
Washington University in St. Louis School of Medicine

Friday, October 16, 2015

University of Michigan North Campus Research Complex (NCRC), 2800 Plymouth Road,
Ann Arbor, MI 48109 -- Building 10, Research Auditorium [Enter through Building 18]

- 8:00-9:00 AM **Registration / Continental Breakfast**
- 9:00-9:15 AM **Welcome** – Julian Wan, MD, President, Nesbit Society /
Mike Kozminski, MD, Secretary-Treasurer, Nesbit Society
- 9:15-9:30 AM **"National Trends in the Utilization of Male Incontinence Surgeries"**
Yahir Santiago-Lastra, MD
Female Pelvic Medicine and Reconstructive Surgery Fellow, Department of Urology,
University of Michigan
- 9:30-9:45 AM **"Bladder Cancer in Neurogenic Bladder Patients"**
Anne Pelletier Cameron, MD
Associate Professor, Department of Urology, University of Michigan
- 9:45-10:00 AM **"Comparative Effectiveness of Bladder Management Strategies"**
John T. Stoffel, MD
Associate Professor, Department of Urology, University of Michigan
- 10:00-11:00 AM **Keynote Lecture "PSA Screening: What We Have Learned and the Way Forward"**
Gerald L. Andriole, Jr., MD
Robert K. Royce Distinguished Professor of Urologic Surgery
Chief, Division of Urologic Surgery
Washington University in St. Louis School of Medicine
- 11:00-11:15 AM **Break**
- 11:15-11:45 AM **Guest Speaker "Instilling Leadership and Responsibility in a New Generation"**
Greg Harden
Supervisor of the Performance Psychology Center
Associate Athletic Director
University of Michigan Athletic Department
- 11:45 AM-12:15 PM **Department of Urology Group Photographs**
#1 All participants and guests
#2 Dr. Andriole and Mr. Harden, faculty and residents
#3 Dr. Andriole and Mr. Harden and faculty
#4 Faculty and residents
#5 Faculty
#6 Nesbit Honored Alumni: 2010, 2005, 2000, 1995, 1990, etc.
- 12:15-1:15 PM **Lunch**
NCRC Building 18, Dining Hall

Friday, October 16, 2015 (Continued)

- 1:15-1:30 PM **"Phase I Study of BCG Followed by Sunitinib for High Risk Non-Muscle Invasive Bladder Cancer"**
Alon Z. Weizer, MD, MS
Associate Professor, Department of Urology, University of Michigan
- 1:30-1:45 PM **"Good Vibrations"**
Jens Sønksen, MD, PhD, DMSci
Professor of Urology, University of Copenhagen
- 1:45-2:00 PM **"Pediatric Endourology"**
Kate Kraft, MD
Assistant Professor, Department of Urology, University of Michigan
- 2:00-2:15 PM **"Transvaginal Pelvic Prolapse Repair"**
Mike Kozminski, MD
Assistant Professor, Department of Urology, University of Michigan
- 2:15-2:30 PM **"Primary Care Versus Urologist Management of BPH"**
Seth A. Strope, MD, MPH
Assistant Professor, Division of Urologic Surgery, Washington University in St. Louis School of Medicine
- 2:30-2:45 PM **Break**
- 2:45-3:00 PM **"Should We Still Prescribe Alpha Blockers for Ureteral Calculi?"**
John M. Hollingsworth, MD, MS
Assistant Professor, Department of Urology, University of Michigan
- 3:00-3:15 PM **"Variation in Osteoporosis Screening and Treatment for Men with Prostate Cancer"**
Ted Skolarus, MD, MPH
Assistant Professor, Department of Urology, University of Michigan
- 3:15-3:30 PM **"Urologic Complications in Diabetes: What We Know - What We Still Need to Learn"**
Aruna V. Sarma, PhD, MHA
Research Associate Professor, Departments of Urology & Epidemiology, University of Michigan
- 3:30-4:00 PM **State of the Department**
David A. Bloom, MD
The Jack Lapides Professor and Chair, Department of Urology, University of Michigan
- 4:00-4:30 PM **Reed Nesbit Business Meeting (*Members Only*)**
Julian Wan, MD, President, Nesbit Society



Important Information

30th Reed M. Nesbit Society & Visiting Professor Meeting
Thursday, October 15 and Friday, October 16, 2015

Registration Deadline - Due by September 30, 2015

Please submit the enclosed Registration Form with payment by September 30. You will receive confirmation receipt by e-mail. Nametags will be available at the scientific sessions on Thursday and on Friday.

Airport Transportation

Detroit Metro Airport (DTW) is located about 30 minutes East of Ann Arbor. Please contact one of the companies listed below to arrange for transportation to and from Detroit Metro Airport:

Arbor Limo	1-734-663-5959	\$74.75 Metro to Ann Arbor or Ann Arbor to Metro (includes Fuel surcharge and gratuities), town car, driver has sign with name
Accent Transportation	1-800-346-9884	\$55 Metro to Ann Arbor/\$45 Ann Arbor to Metro
Ann Arbor Metro	1-734-507-9220	\$60 total Metro to Ann Arbor (1 or group) and \$50 total (1 or group), 7am-7pm, 7days
Blue Cab	1-734-547-2222	\$55 approx. metered service Ann Arbor to Metro only
Metro Taxi & Limo	1-734-975-6898	\$59 Metro to Ann Arbor/\$49 Ann Arbor to Metro, driver has sign with name
Scenic Transport	1-734-330-8726	\$70 Metro to Ann Arbor/\$70 Ann Arbor to Metro
Select Ride Shuttle	1-866-663-8898	\$40 Metro to Ann Arbor/\$33 Ann Arbor to Metro, 1 hr. pick-up window (If booking round trip price is \$31 each way)
Yellow Cab	1-734-663-3355	\$52 either way, Metro to Ann Arbor, or Ann Arbor to Metro

If you prefer to rent a car, maps to Ann Arbor will be available from the rental car companies.

Hotel Information

A block of rooms have been reserved from October 15th thru 18th for our out-of-town guests.

Ann Arbor Regent Hotels and Suites located at 2455 Carpenter Road, Ann Arbor at the special rate of \$120/Thursday night and a rate of \$195/Friday & Saturday nights (Guests are required to stay a minimum of 2-nights, Friday and Saturday evenings, with a 30-day cancellation policy during football weekends. Please call the Ann Arbor Regent early at 1-734-973-6100 and specify the "**Nesbit Society-UM Urology Alumni**" block of rooms. **The rooms will only be held until September 15, 2015.** For more information, visit: <http://www.annarborregent.com>.

Holiday Inn near the University of Michigan located at 3600 Plymouth Road, Ann Arbor at the special rate of \$229.99 per night and at the time of reservation, individual will be responsible for first night deposit. Friday and Saturday night stay required with a 21-day cancellation policy prior to arrival for deposit refund. Please call the Holiday Inn early at 734-769-9800 and specify the "**UM Urology Nesbit**" block of rooms. **The rooms will only be held until September 24, 2015.** For more information, visit: <http://www.hiannarbor.com>.

Suggested Attire

Business casual clothing is appropriate for the meeting and activities. Fall weather in Ann Arbor is variable, so be prepared for both cold and warm weather as well as rain.

Directions and Parking

Thursday, October 15, 2015

University of Michigan Hospital, Patient Parking P2

Towsley Center, Sheldon Auditorium (enter through the Clinical Simulation Center)

1500 E. Medical Center Drive, Ann Arbor, MI 48109

From the North

Take US-23 South, to the Plymouth Road exit (#41). Turn right and follow Plymouth Road approximately 2 miles until you reach Maiden Lane and turn left. (This is the light immediately after Broadway Blvd., with a florist shop on the near left corner.) Continue on Maiden Lane. As you approach the next traffic light, use the center lane to cross Fuller Road. Maiden Lane changes to East Medical Center Dr. as you enter the campus.

From the South

Take US-23 North to the Washtenaw Ave./BR23 exit (#37B) toward Ann Arbor. Merge onto Washtenaw Ave. and follow it approximately 1 mile until you reach Huron Parkway. Turn left at the second stop light at Fuller Road. As you continue on Fuller, you will pass the Veterans Hospital and be able to see the Health System campus on the hill to your left. At the traffic light at Fuller and Maiden Lane/ East Medical Center Drive, turn left.

From the East

Take I-94 West to US-23 North (exit 180B). Take the Washtenaw Ave./BR23 exit (#37B) toward Ann Arbor. Merge onto Washtenaw Ave. and follow it approximately 1 mile until you reach Huron Parkway and turn right. When you reach the second traffic light, turn left onto Fuller Road. As you continue on Fuller, you will pass the Veterans Hospital and be able to see the Health System campus on the hill to your left. At the traffic light at Fuller and Maiden Lane/ East Medical Center Drive, turn left.

From the West

Take I-94 east to Ann Arbor (exit 172). This merges into Jackson Rd. (Eastbound). Remain on Jackson, which becomes Huron, and continue for 2.5 miles through downtown. At the traffic light at Glen and Huron, turn left onto Glen. Go straight through 3 stop lights on Glen. At the fourth stop light, turn right onto East Medical Center Drive.

Parking Options

The valet parking and patient drop off loop is located on the right side of East Medical Center Dr, after you pass the Emergency entrance. Valet services are available from 6:30 a.m.-7 p.m. M-F, and 7 a.m. to 5 p.m. on weekends, for \$5. Motorized scooters are also available for loan, at this entrance. Self-parking is available at the P2 structure. The Towsley Center, Sheldon Auditorium is located on the 2nd Floor. You will want to enter through the Clinical Simulation Center.

Directions and Parking (Continued)

Thursday, October 15, 2015

University of Michigan Hospital, Patient Parking P2

Towsley Center, Sheldon Auditorium (enter through the Clinical Simulation Center)

1500 E. Medical Center Drive, Ann Arbor, MI 48109

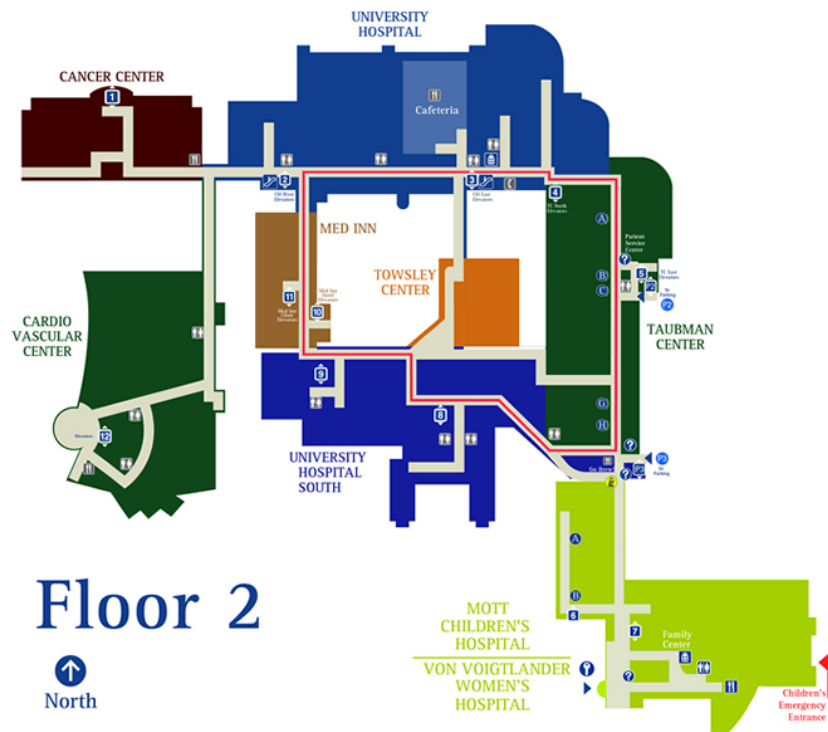
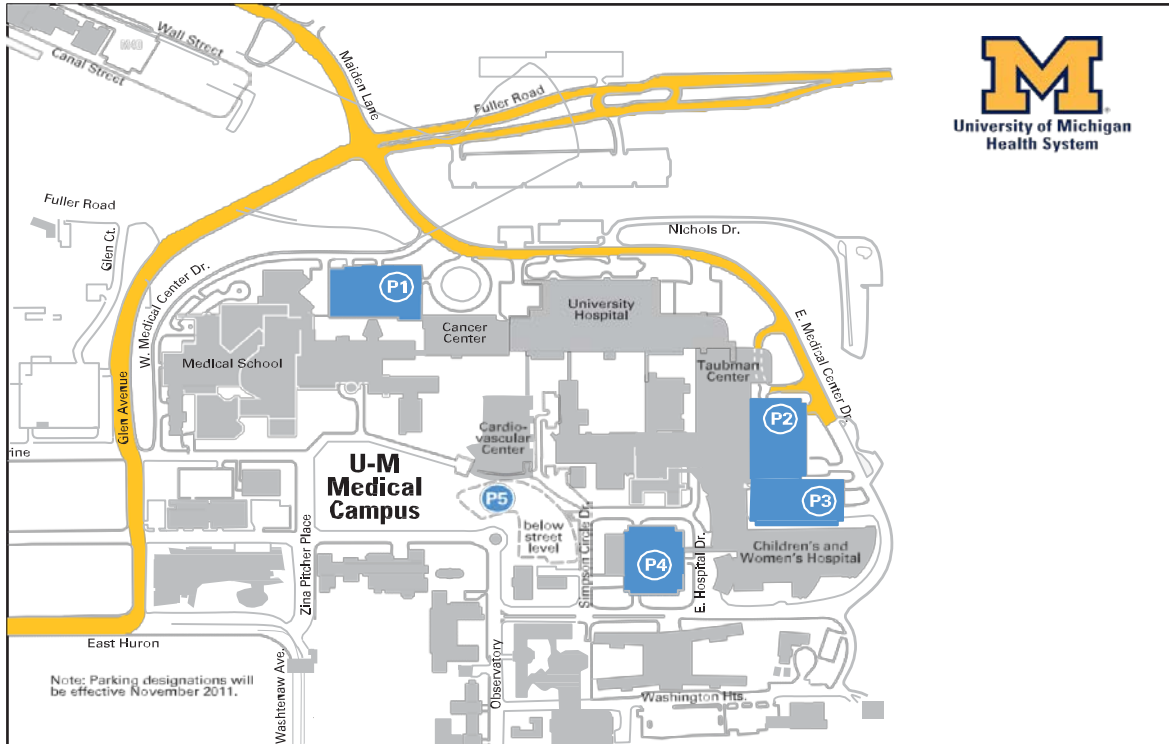

Directions and Parking
Friday, October 16, 2015, University of Michigan
North Campus Research Complex (NCRC)
2800 Plymouth Road, Ann Arbor, 48109

From East (north side of town): Take M-14 to US-23 south. Follow US-23 south to Plymouth Road exit (41); Turn right (west) onto Plymouth Road. Continue .9 miles to Huron Parkway. Go through the intersection at Huron Parkway and continue on Plymouth to Nixon Road. At Nixon (there is a light), get into the left turn lane which is at the 2800 Plymouth Road entrance to the North Campus Research Complex (there is a sign at the entrance). Enter the complex and follow the drive as it curves first to the right (near the Child Care Center) and then to the left past Building 16. Visitor parking will be on the left. Visitor entrance to the complex is at Building 18.

From East (south side of town): Take I-94 west to US-23 north. Follow US-23 north to Plymouth Road exit (41); Turn left onto Plymouth Road. Continue .9 miles to Huron Parkway. Go through the intersection at Huron Parkway and continue on Plymouth to Nixon Road. At Nixon (there is a light), get into the left turn lane which is at the 2800 Plymouth Road entrance to the North Campus Research Complex (there is a sign at the entrance). Enter the complex and follow the drive as it curves first to the right (near the Child Care Center) and then to the left past Building 16. Visitor parking will be on the left. Visitor entrance to the complex is at Building 18.

From West (north side of town): Take I-94 east to M-14 (goes northeast). Take M-14 to US-23 south. Follow US-23 south to Plymouth Road exit (41); Turn right (west) onto Plymouth Road. Continue .9 miles to Huron Parkway. Go through the intersection at Huron Parkway and continue on Plymouth to Nixon Road. At Nixon (there is a light), get into the left turn lane which is at the 2800 Plymouth Road entrance to the North Campus Research Complex (there is a sign at the entrance). Enter the complex and follow the drive as it curves first to the right (near the Child Care Center) and then to the left past Building 16. Visitor parking will be on the left. Visitor entrance to the complex is at Building 18.

From West (through downtown): Take I-94 to Jackson Road exit. Go east on Jackson Road which becomes Huron Street. Follow Huron Street east to Division Street. Turn left (north) on Division Street. Follow Division north as it goes over the Broadway bridge and becomes Broadway Street. Follow Broadway until it merges with Plymouth Road, just past Maiden Lane. Continue east on Plymouth Road (get in the right lane) to Nixon Road. At Nixon (there is a light), turn right at the 2800 Plymouth Road entrance to the North Campus Research Complex (there is a sign at the entrance). Enter the complex and follow the drive as it curves first to the right (near the Child Care Center) and then to the left past Building 16. Visitor parking will be on the left. Visitor entrance to the complex is at Building 18.

From North: Take US-23 south to Plymouth Road exit (41). Turn right (west) onto Plymouth Road. Continue .9 miles to Huron Parkway. Go through the intersection at Huron Parkway and continue on Plymouth to Nixon Road. At Nixon (there is a light), get into the left turn lane which is at the 2800 Plymouth Road entrance to the North Campus Research Complex (there is a sign at the entrance). Enter the complex and follow the drive as it curves first to the right (near the Child Care Center) and then to the left past Building 16. Visitor parking will be on the left. Visitor entrance to the complex is at Building 18.

From South: Take US-23 north to Plymouth Road exit (41). Turn left onto Plymouth Road. Continue .9 miles to Huron Parkway. Go through the intersection at Huron Parkway and continue on Plymouth to Nixon Road. At Nixon (there is a light), get into the left turn lane which is at the 2800 Plymouth Road entrance to the North Campus Research Complex (there is a sign at the entrance). Enter the complex and follow the drive as it curves first to the right (near the Child Care Center) and then to the left past Building 16. Visitor parking will be on the left. Visitor entrance to the complex is at Building 18.

Directions and Parking (Continued)
Friday, October 16, 2015, University of Michigan
North Campus Research Complex (NCRC)
2800 Plymouth Road, Ann Arbor, 48109

Once you reach NCRC....

1. Please follow the signs and park in the NCRC Parking Deck (BLUE structure).
2. A parking attendant will be on-site to distribute a complimentary parking pass if you do not already have a “BLUE or GOLD” UM parking permit.
3. Building 18 is right across the street (entrance indicated by the PURPLE circle) and signs will be available to help guide you.
4. Enter Building 18 and take the elevator or stairs to the 2nd Floor. Follow the signs to Building 10, Research Auditorium.



Information/Questions:

Please contact Sandra Heskett at 734-232-4943 or sheskett@umich.edu if you have any further questions or need assistance.