



MICHIGAN MEDICINE
UNIVERSITY OF MICHIGAN

Network of Postdoctoral Training Programs in Psychology

Michigan Medicine / VA Ann Arbor

Clinical Child Psychology
Clinical Neuropsychology Consortium
Clinical Psychology Consortium
SMITREC VA Fellowship Program



MICHIGAN MEDICINE
UNIVERSITY OF MICHIGAN

Rachel Upjohn Building

MICHMED Clinical Adult



WITH HEARTFELT
**GRATITUDE
 AND
 APPRECIATION**
 we dedicate this wall to the individuals
 and organizations whose generosity in opening
 the doors to a brighter future in the fight
 against depression, bipolar disorders,
 and all brain illnesses.
 Thank you for your vision, commitment,
 and support. Together, we are creating new
 pathways to health and wellness.

CHAMPIONS
 ESTABLISHED 2002

MARY* & EDWIN* MEADER
*"It is my hope that the Depression Center will
 improve treatments and be a
 model for the rest of the country."*
 Mary* & Edwin* Meader

VISIONARIES
 ESTABLISHED 2002

THOMAS E. ALLEN
 ROBERT HUNT BERRY
 BRAIN & BEHAVIOR RESEARCH FOUNDATION
 RAYTOL MYERS SQUIBB COMPANY
 THE COHEN FAMILY FUND
 TRICIA HARRISON CRANDALL
 REILLY AND COMPANY FOUNDATION
 ETHEL AND ILMAR FINN FOUNDATION
 KAMEL AND JEAN FRANZ
 HEALTH AND RESEARCH FOUNDATION
 PHIL JENKINS FAMILY
 RICHARD SCOTT NOBLE*
 HEINZ C. FRECHTER* AND WALTER D. E. FRECHTER
 WORLD HERITAGE FOUNDATION
 FRECHTER FAMILY FUND
 THE RAVITZ FOUNDATION
 JEANNE ROBERTSON
 THE SCHWARTZBERG FAMILY
 CARLOS SOLANO-LOPEZ, M.D.
 HELMUTH AND CAROL EFRAN
 THE RICHARD FIRM FOUNDATION
 WELCOME BACK VETERANS
 A MCCORMICK FOUNDATION
 AND MAJOR LINDSEY BASSALE INITIATIVE
 THOMAS R. AND NANCY* G. WOODWORTH

CATALYSTS
 ESTABLISHED 2002

ANONYMOUS
 DANIEL R. AND MARGARET W. CARROLL
 FELLOW OF
 THE UNIVERSITY OF MICHIGAN HEALTH SYSTEM
 ROBERT WOOD JOHNSON FOUNDATION
 BETTY AND MICHAEL MACKEY
 PETER AND LUCAN BEHNKE
 MIC & ANNE RABY* MERRILL
 WHEELER FAMILY OF COLORADO

TRAILBLAZERS
 ESTABLISHED 2002

ANNOUNCING DR.
 APFELBERG'S POLYMERASE CHAIN
 JACK J. BERNAL, M.D. AND KATHERINE A. BERNAL, PH.D.
 DEPT. OF CELL BIOLOGY
 FOR GREGORY A. HARRIS FOUNDATION
 JOHN AND JANE QUINN
 MARSHALL W. BROWN
 JAMES M. KLING JR., ESQ.
 PHILIP MORRIS LIMITED FUND
 CLARENCE HARRIS
 THE CLARENCE HARRIS FOUNDATION AND THE "CLARENCE HARRIS"
 JOHN AND RACHEL LINDNER
 THE GRAYSON FOUNDATION
 HENRIETTA AND ROBERT BIRD
 MICHAEL AND LARAE GIBBERTY
 WILLIAM AND WILLIAM BALE
 GUY AND BILL HARRISON
 DAN LARSON* AND JUDITH LARSON
 AL* AND COLLETTA BROWN
 PHILIP AND JANE BROWN FOUNDATION
 PHILIP AND JANE BROWN
 MICHAEL AND JANE BLANTON* FOUNDATION
 STEVEN AND
 MICHELLE* AND RAY* PERLSON
 M. DENNIS GARDNER
 DEAN F. HUNTER* AND BARBARA A. WOODSON
 DR. ALBERT F. HOFFMANN* AND BRUCE M. WOODSON
 BRUCE AND MICHAEL HOFFMANN
 WYATT* A. SMITH
 ALAN F. AND MARGARET J. HOFFMANN
 DONALD J. SMITH FOUNDATION
 MICHAEL AND JANE WILSON* FOUNDATION
 PHILIP MORRIS CHILDREN'S FOUNDATION
 DR. AND MRS. JOHN G. VAN BUREN
 JERRY AND MARGARET WOODSON
 ESTER W. WOODWARD

PACESETTERS
 ESTABLISHED 2002

ALAN F. AND MARGARET J. HOFFMANN
 DONALD J. SMITH FOUNDATION
 MICHAEL AND JANE WILSON* FOUNDATION
 PHILIP MORRIS CHILDREN'S FOUNDATION
 DR. AND MRS. JOHN G. VAN BUREN
 JERRY AND MARGARET WOODSON
 ESTER W. WOODWARD

INNOVATORS
 ESTABLISHED 2002

ALAN F. AND MARGARET J. HOFFMANN
 DONALD J. SMITH FOUNDATION
 MICHAEL AND JANE WILSON* FOUNDATION
 PHILIP MORRIS CHILDREN'S FOUNDATION
 DR. AND MRS. JOHN G. VAN BUREN
 JERRY AND MARGARET WOODSON
 ESTER W. WOODWARD

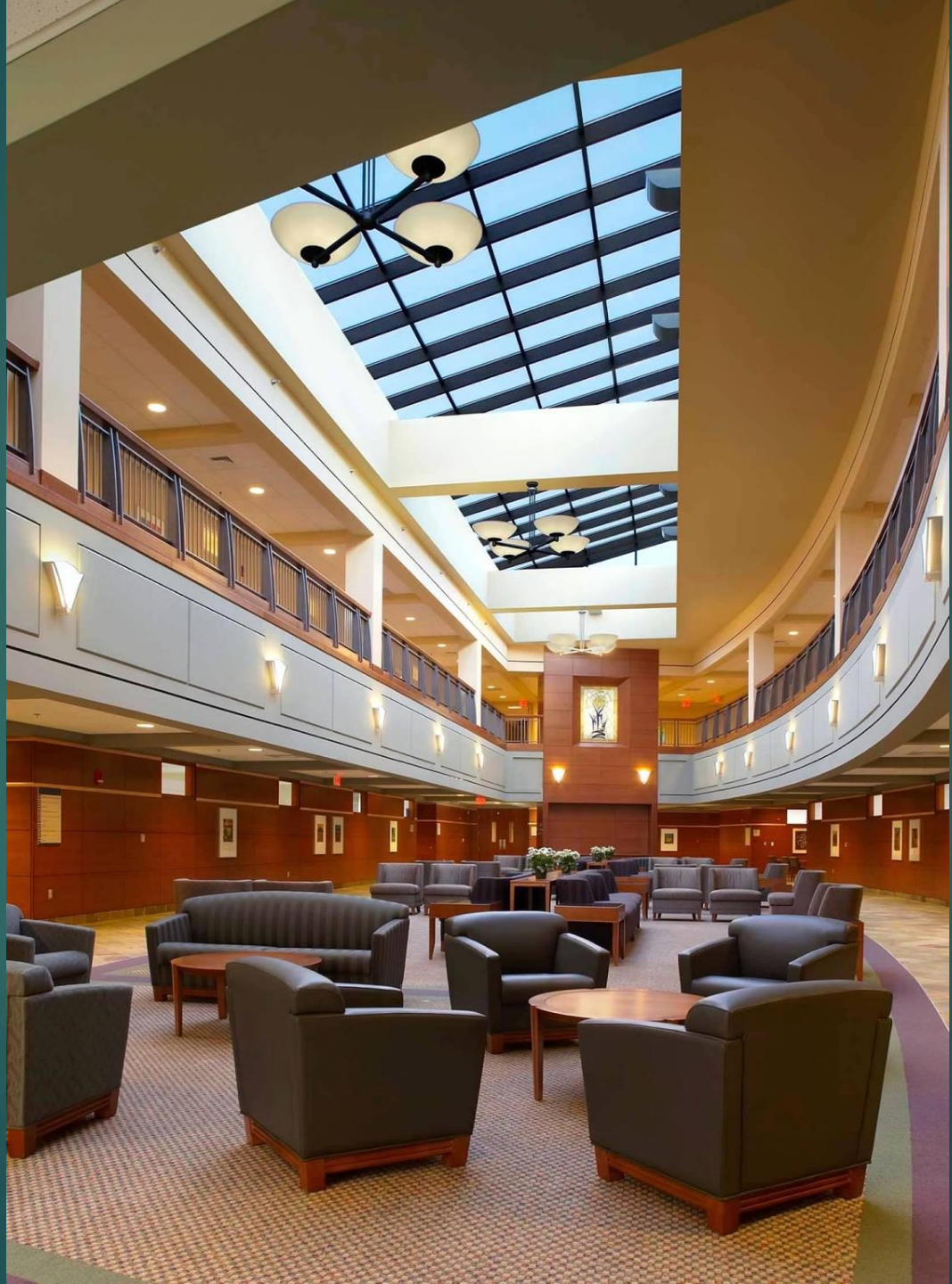









MICHIGAN MEDICINE
UNIVERSITY OF MICHIGAN

VA Ann Arbor Medical Center

VA Clinical Adult



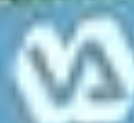

Department of
Veterans Affairs

Ann Arbor
Healthcare System



ALERT
Serves Floors B, 1-9
Liberty Elevators

EXIT

RESTROOMS

6

6

Office of Nursing
My Smokin' Cessatio Workbook
Smoking Cessation
Smoking Cessation Workbook

SMOKE FREE









EXIT

FIRE
EXTINGUISHER

Clinical
Psychologist
Minden Seston, PhD
A740

STATION 7.8 Mental Health Self Check-In

VETERAN "X"
VEIS HELPING VETS
Veteran "X" is a voluntary peer-led, mental health needs assessment program helping an veteran understand and understand for a more informed decision. Veterans who are prepared for a challenging career to take in a new job or changing career.

VA
Mental Health Self-Check-In

VA
BUS
A shuttle bus is available between the VA and the community center. Please call the community center for more information.

IF YOU HAVE A COUGH OR SNEEZE
Please call the community center for more information.

Authorized Staff Only

HONORABLE SERVICE
Department of Veterans Affairs

NO ONE CAN OWN A FIREARM
FREE GUNLOCKS FOR VETERANS

Please let us know if this is your first visit to the Mental Health Clinic. Thank you.

VA
Mental Health Self-Check-In

ATTENTION
For Patient Privacy Please Wait Until Called





